



solen

RESIDENCE



JAMAL LIVING



solen

RESIDENCE

JAMAL
LIVING

JAMAL LIVING

SOLEN RESIDENCE

*A quiet, yet elegant blend of thoughtful design,
and a lifestyle shaped by purpose and care.*



SOLEN
RESIDENCE

01



solen
RESIDENCE

Solen introduces a grounded, natural aesthetic to Dubai Silicon Oasis - a place where architecture, atmosphere, and everyday function work in harmony.

With gentle materials, thoughtful proportions, and seamless layouts, Solen isn't just a place to live, it's a retreat crafted to bring clarity, calm, and a sense of connection.



1, 2 & 3
BEDROOM UNITS



Rooftop
INFINITY POOL



85+
THOUGHTFULLY DESIGNED
RESIDENTIAL UNITS



Advanced
HOME AUTOMATION



DEDICATED CINEMA ROOM



Fully Equipped
STATE-OF-THE-ART GYM



Built-in
KITCHEN APPLIANCES



2 Floors
OF COVERED PARKING

DUBAI SILICON OASIS

Is one of the most city's forward-thinking communities, a vibrant, self-sustained hub where living, learning, and innovation come together.

Solen's location offers seamless access to daily essentials, business centers, and cultural hubs, all while preserving a peaceful residential atmosphere.



JAMAL LIVING

SOLENE RESIDENCE

DUBAI SILICON OASIS

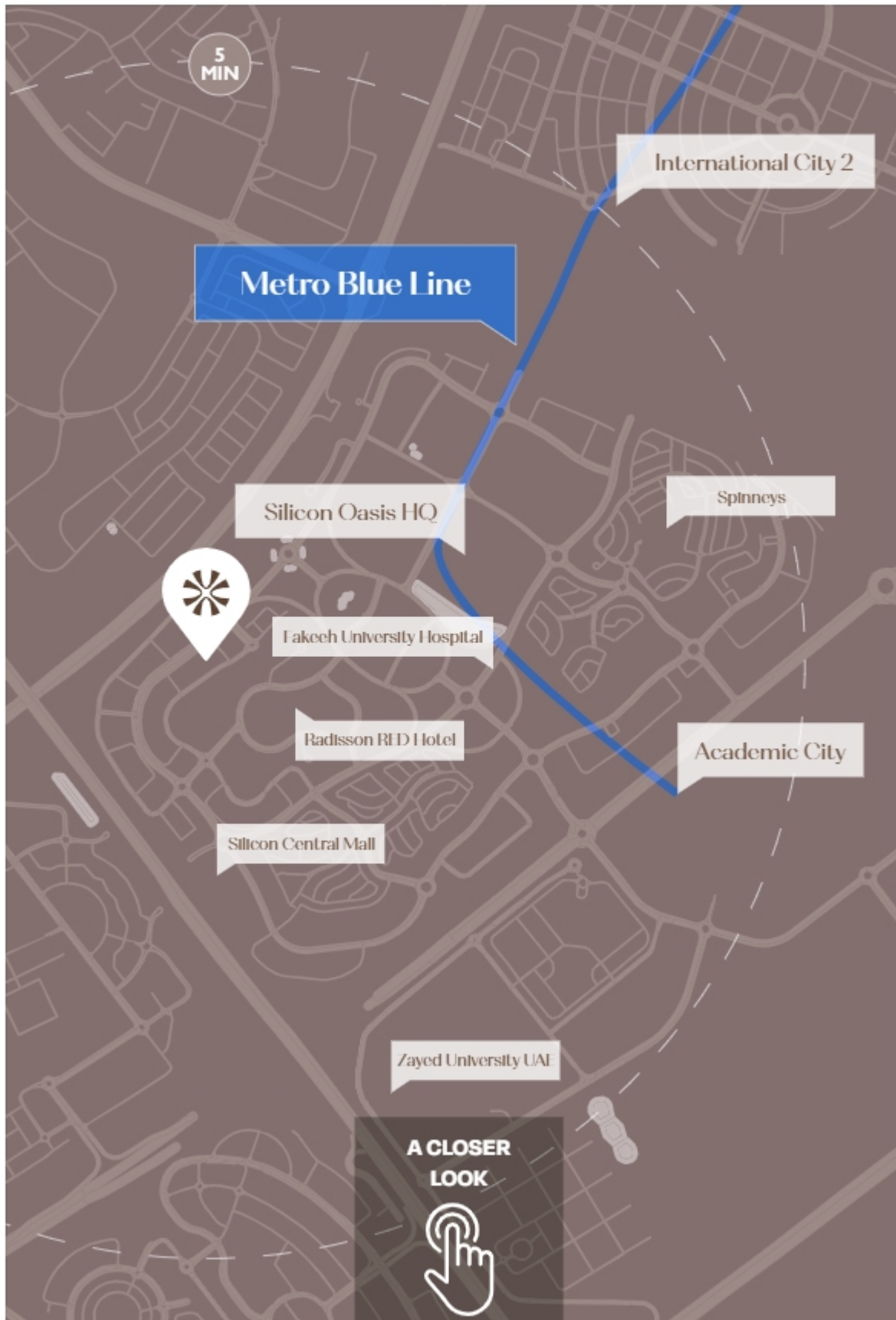

FEATURES & AMENITIES

02

INFINITY POOL

Temperature-controlled infinity pool, with shaded lounge areas for relaxation.



JAMAL LIVING

SOLENT SCIENCE



DEDICATED AREAS

Safe and shaded, designed for families with dedicated workspaces.



JAMAL LIVING

SOLENE RESIDENCE



FITNESS CENTER

Elevate your lifestyle with fully equipped, state-of-the-art fitness facilities



JAMAL LIVING

SOLENIUM SCIENCE

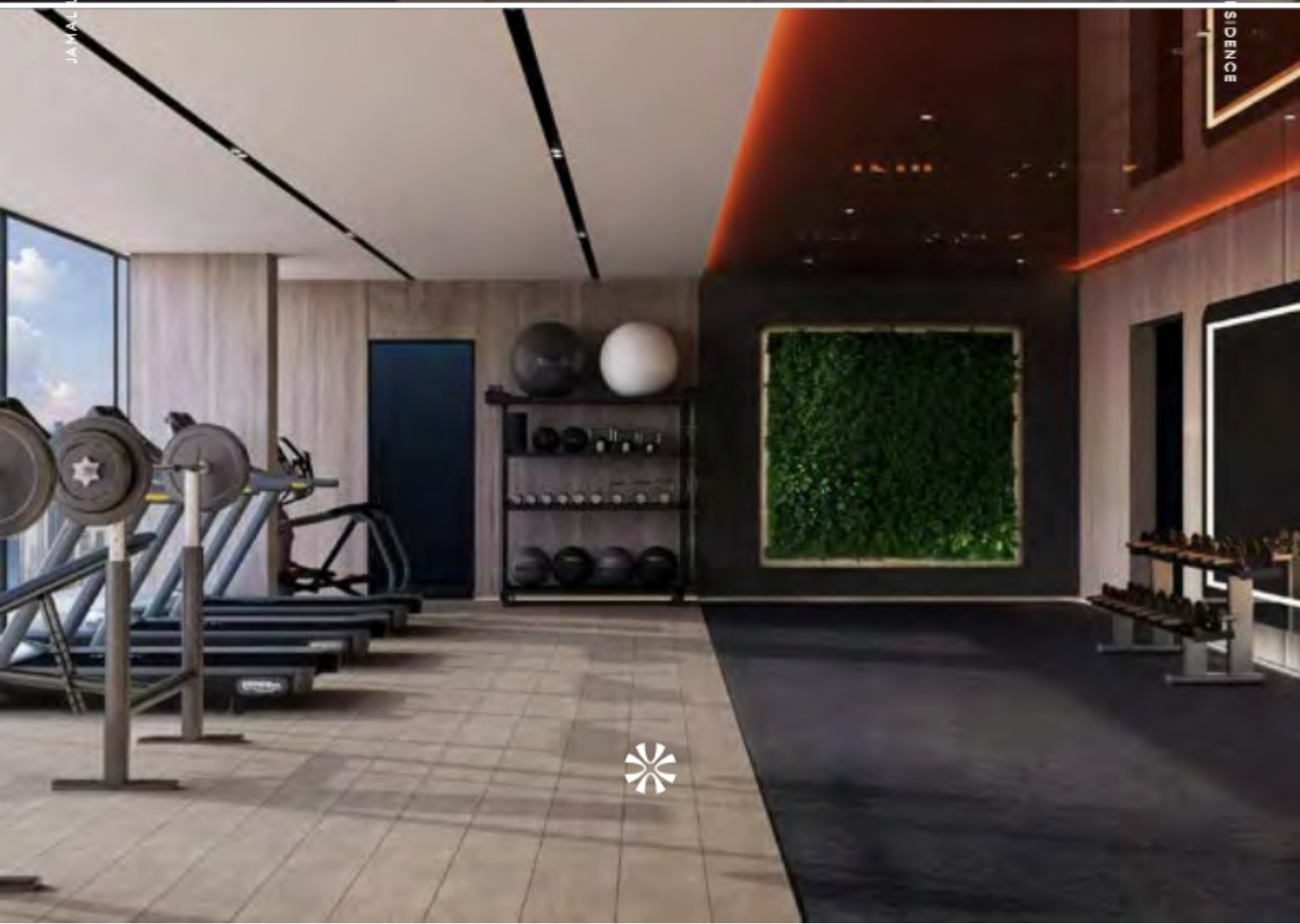

PRIVATE CINEMA

A private cinema crafted exclusively for residents to enjoy movies in style.



JAMAL LIVING

SOLENI RESIDENCE



FLOOR PLANS
& UNIT TYPES

04

1-BEDROOM RESIDENCES

Balanced and efficient, ideal for individuals and couples seeking clarity in space.



All drawings and dimensions are approximate. Drawings are not to scale and are subject to change without notice. The developer reserves the right to make revisions. The units are taken from the typical floor of the building and columns may vary in size depending on the floor level. The furnishings and accessories shown are for representation only. The length and width of the unit and balcony varies depending on which floor and which orientation the unit is located within the building to comply with the building authority regulations.



2-BEDROOM RESIDENCES

Spacious layouts thoughtfully designed for shared living, featuring abundant natural light and generous storage.



JAMAL LIVING

SOLE RESIDENCE

All drawings and dimensions are approximate. Drawings are not to scale and are subject to change without notice. The developer reserves the right to make revisions. The units are taken from the typical floor of the building and columns may vary in size depending on the floor level. The furnishings and accessories shown are for representation only. The length and width of the unit and balcony varies depending on which floor and which orientation the unit is located within the building to comply with the building authority regulations.



2-BEDROOM TERRACE RESIDENCES

Spacious layouts designed for shared living, with ample storage and light, with private plunge pools in limited units.



All drawings and dimensions are approximate. Drawings are not to scale and are subject to change without notice. The developer reserves the right to make revisions. The units are taken from the typical floor of the building and columns may vary in size depending on the floor level. The furnishings and accessories shown are for representation only. The length and width of the unit and balcony varies depending on which floor and which orientation the unit is located within the building to comply with the building authority regulations.



3-BEDROOM TERRACE RESIDENCES

Generously proportioned homes for families or those needing more breathing room, with private plunge pools in limited units.



All drawings and dimensions are approximate. Drawings are not to scale and are subject to change without notice. The developer reserves the right to make revisions. The units are taken from the typical floor of the building and columns may vary in size depending on the floor level. The furnishings and accessories shown are for representation only. The length and width of the unit and balcony varies depending on which floor and which orientation the unit is located within the building to comply with the building authority regulations.



ABOUT
JAMAL LIVING

05



With over 30 years of development experience across the UAE, Jordan, and Qatar, Jamal Living has earned its reputation through attention to detail, genuine care, and a strong commitment to quality.

As a boutique developer, we take a personal approach to every project.

From start to finish, we're fully involved, making sure each project reflects lasting quality, timeless design, and careful craftsmanship.



Jamal Living redefines modernity through meticulously crafted residences that blend elegance, function, and enduring quality.

Each development is a reflection of their uncompromising standard, where architectural finesse meets thoughtful design, and every detail is curated to elevate daily living.





From the park-adjacent charm of The Lily to the urban sophistication of Azure Residence, their portfolio showcases a commitment to excellence and timeless appeal.

Known for delivering on time without compromising craftsmanship, Jamal Living creates more than buildings; they create distinguished addresses for those who value beauty, comfort, and a lifestyle without compromise.





30+ years

of collective industry expertise

20+

completed and ongoing developments across Dubai

1,200+

residential and commercial units delivered

25,000 sqm+

of built-up area across key locations

98%

on-time project completion rate

100%

compliance with Dubai's green building regulations

Zero

major defects post-handover in the past 5 years

90% +

client retention and referral rate

betterhomes

Get in touch





JAMAL LIVING



solen

RESIDENCE